

Touch Free Control AirScan

IR-Laser Multi-Touch

Motion controlled user interfaces add a new dimension to interactive multimedia display and presentation solutions. The coolux AirScan system combined with the Widget Designer PRO allows for touch free interactivity. They offer the opportunity to interact with digital content in ways not possible with traditional displays.



The AirScan control interfaces allow for custom design and integration of interactive displays that let users navigate menu based multimedia presentations in any environment.

As part of a Pandoras Box Playback solution Full HD video presentations can be controlled from any distance and projected onto any sized screen with no mouse or pointing device required.

Large Scale Scanning Range

Touch free solutions can be set up and integrated for various applications. AirScan can be used at distances of up to 10 m / 30ft. It features up to 24 Multi-Touch points.

Advanced Motion Stabilizing

The built-in motion stabilizer allows these advanced input devices to be used on large scale displays by offering high speed processing and damping of the sensor motion data.

Dynamic Gesture Menu Programming

Widget Designer PRO allows the designer to set up unlimited menu page configurations, allowing the interactive display to be easily customized.

The Widget Designer PRO interface requires no special programming skill and is quickly set up.

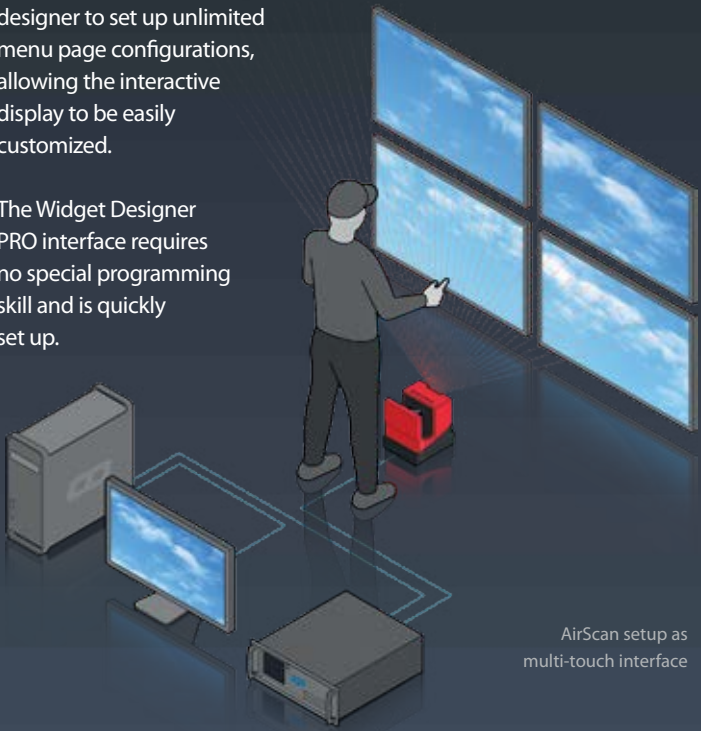

AirScan setup as multi-touch interface



Touch Free Control

AirBar

AirBar Features

The AirBar system is based on a measuring infrared light curtain. The unit provides min/max and hole detection for further control processing.

A single system consists of a transmitter and receiver bar and connects to Widget Designer PRO via an RS232 interface.

With a minimum pitch of 5mm AirBars offer high resolution motion data that can be linked to one or more Pandoras Box playback systems for mouse, layer or parameter movements.

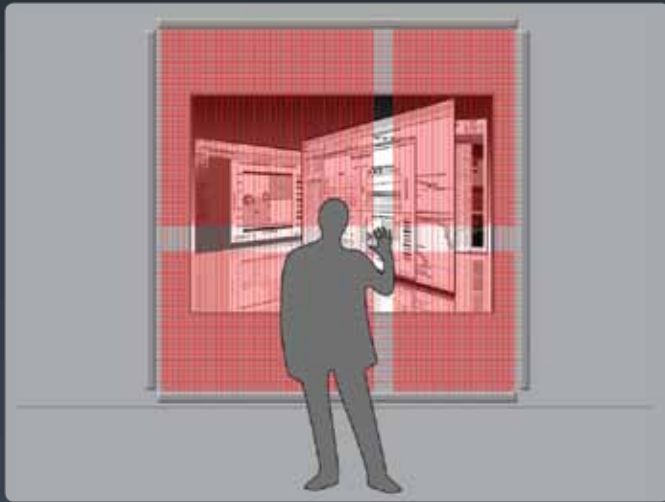

For two axis and multitouch control multiple systems can be combined.

The maximum length per sender/receiver pair is 3200mm and up to 4 pairs with up to 512 beams can be processed at once.

AirBar allows the designer to use multiple sender/receiver pairs to retrieve X&Y input coordinates that can be assigned to any device parameter within the Pandoras Box control architecture.

Single sender and receiver pairs can be set up for single axis control and distance measuring. This allows AirBar to control the motion and scaling at the same time.

Individual gestures like left, right, up or down motion can be assigned to run customizable scripts and controls.

The possibilities are countless.

Please feel free to contact coolux or one of our partners for further questions and let us know how you would like to implement AirBar solutions in your projects.

Two systems can be combined for example to locate individual intersections for mouse movements and button control.

By measuring the distance between two intersections distance and angle values can be retrieved to control.

2D or 3D video rotation and scale parameters.



AirBar transmitter & receiver with 5mm LED pitch

In the example shown a possible scenario could be:

- X&Y motion controls layer positioning
- X distance controls layer scaling
- Y distance control layer rotation

With Widget Designer PRO all settings can be configured and changed per page, which offers an outstanding flexibility in setups for interactive menus.

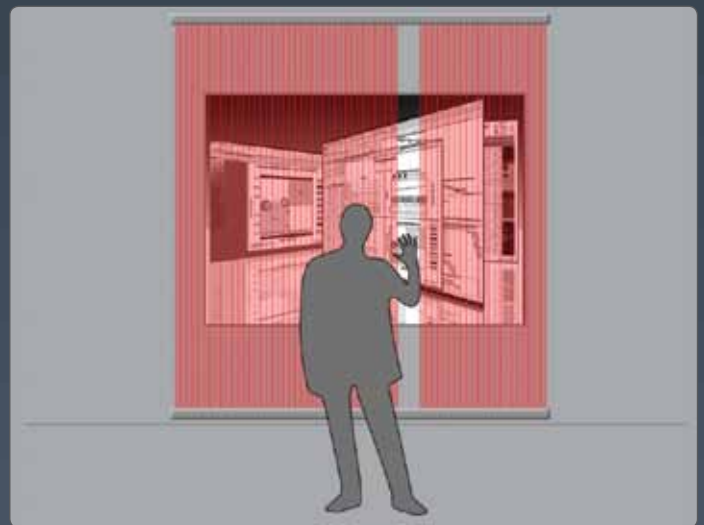

Single axis control with a vertical AirBar for horizontal motion.



UK Exclusive Distribution

Production Supplies & Services Worldwide

tmb-info@tmb.com

LOS ANGELES

LONDON

NEW YORK

BEIJING

TORONTO

Tel: +1 818.899.8818

Tel: +44 (0)20.8574.9700

Tel: +1 201.896.8600

Tel: +86 10.8492.1587

Tel: +1 519.538.0888

© TMB